

## Defrost Vent/Register Blend Door Actuator - LHD (80.10.36)

### Removal

1. Remove the glove compartment. For additional information, refer to [Instrument Panel Console \(76.25.03\)](#) (Section 501-12)
2. Remove the passenger side closing trim panel.
  - ▶ Release the clip.
  - ▶ Remove the 2 screws.
  - ▶ Disconnect the electrical connector.

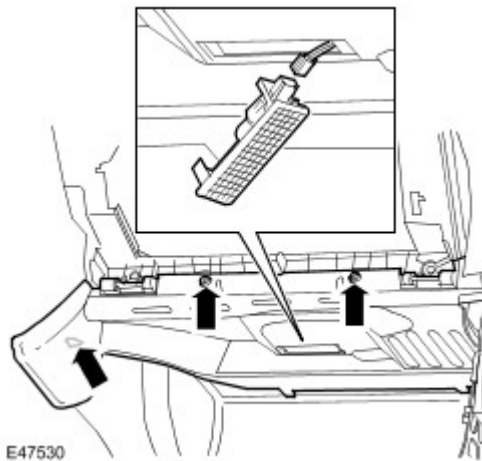

3. Remove the passenger side footwell duct.
  - ▶ Remove the clip.

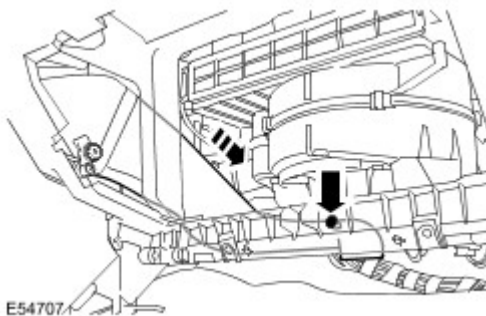

4. Remove the passenger side footwell duct elbow.
  - ▶ Remove the 2 Torx screws.

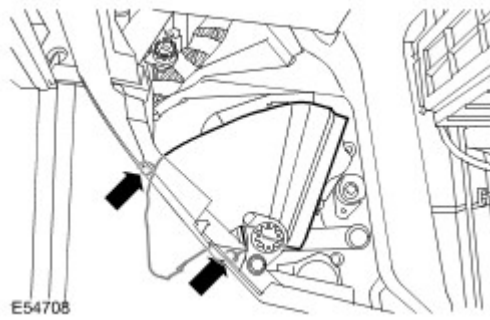

5. Remove the defrost door actuator.
  - Disconnect the electrical connector.
  - Remove the 2 screws.

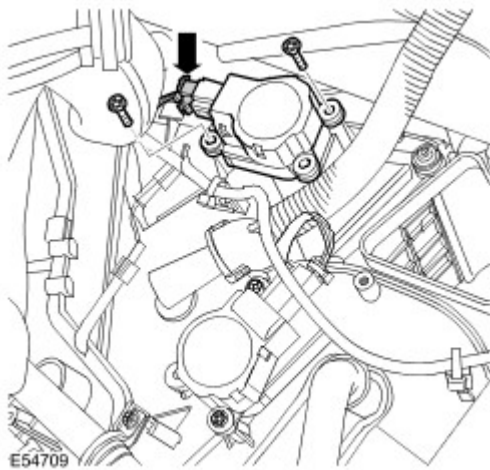

## Installation

1. Install the defrost door actuator.
  - Tighten the screws.
  - Connect the electrical connector.
2. Install the passenger side footwell duct elbow.
  - Tighten the screws.
3. Install the passenger side footwell duct.
  - Install the clip.
4. Install the passenger side closing trim panel.
  - Install the interior lamp.
  - Connect the electrical connector.
  - Secure the clip.
5. Install the glove compartment. For additional information, refer to [Instrument Panel Console](#)

[\(76.25.03\)](#) (Section 501-12)