

Bessacarr  
Caravans  
2001



INDIVIDUALLY STYLED | BEAUTIFULLY BUILT



# Bessacarr Caravans

The all new range of Bessacarr Cameo single and twin axle tourers brings a new dimension to the world of luxury touring for 2001.

From the classical lines of the individually styled exteriors to the exclusive profile of the crafted interiors, the designers have created an appeal that is without equal.

All backed by a privileged service from specially selected dealers, and a comprehensive three year manufacturer backed SuperSure warranty, which adds a final luxury - total peace of mind.

*A Tourer for all Seasons*



Cameo 325



Cameo 550

2001 Season





# Cameo Range

An equipment level which includes a microwave oven,<sup>†</sup> luxury flush fitting stainless steel kitchen equipment with Stoves slot in oven, recessed sink, utensil rack,<sup>†</sup> vast new Electrolux power fridge, Primus wet central heating<sup>†</sup> and the very latest washroom designs, leaves little for the imagination - except to picture yourself relaxing in the luxury surroundings.



Cameo 525



Cameo 535



Cameo 550



<sup>†</sup> In some models.

# Features



- New models - 495SL, 525SL, 535SL, 625SL
- EXTERIOR**  
New for 2001
- Seitz S4 framed flush fitting window system, to side & rear windows
- Fully sealed wet locker with 230v external socket
- External access door under fixed beds (535SL & 625GL only)
- Increased A frame length for improved stability
- AKS 2700 stabiliser fitted as standard
- Stabiliform heavy duty corner steadies

- Stylish graphics
- Revised hitch cover with courtesy light
- Manually switched awning light on offside
- External aerial socket in battery box
- Alloy wheels fitted as standard (13" 550GL & 625GL, 15" 495SL, 525SL & 535SL)



- Aspen white exterior colour
- One-piece stylish GRP front and rear panels
- Wrap round rear light cluster with stop/tail, fog and reversing lights
- Rear high level brake light



- Gas bottle box with swing up lid with gas strut also featuring moulded dedicated gas locker floor for 2 gas cylinders
- External access heated locker (not 535SL or 625GL)
- Front windows with concealed fixings



- Heavy duty stainless steel grab handles to front, rear and gas locker door
- Winter fridge vent covers
- Dedicated spare wheel stowage including spare wheel and tyre
- Gas barbecue point on nearside
- Side repeater directional indicator lights
- TV aerial and booster
- Telescopic radio aerial with built in application body structure
- Side mounted jacking point with scissor jack
- Exterior quick release door retainer
- All models comply with European standards

- Al-Ko galvanised steel chassis with euro axle
- Low level rubbing stakes incorporating awning skirt channel
- Awning channel on both sides of caravan
- Battery box with mains electrics input battery terminal and restraint strap (excluding battery)

## BODY STRUCTURE

- 44mm bonded floor with styrofoam insulation core
- 32mm fully bonded one-piece roof (except front sweep)
- 25mm bonded side walls with polystyrene insulation core



## ELECTRICAL

New for 2001

- Halogen 12v ceiling lights
- Improved courtesy light in wardrobe and cocktail cabinet
- Exclusive 12v downlights
- ESM charger unit



- Mains lights with dimmer switch control
- Low level floor courtesy and night lighting two way switch from doorway to front beds
- Generous supply of 230v mains sockets (minimum 4 internal and 1 external)
- Two TV stations with 230v/12v aerial connection point (550GL has video storage facility)
- 25 metre on site mains connection lead
- Spark ignition oven/hob and grill unit
- Electronic ignition to fridge
- Programmable timer thermostat for wet central heating system (535SL, 550GL and 625GL only)



## WASHROOM, HEATING & PLUMBING

- Truma 3002A heater and ultra-heat blown air (495SL and 525SL only)
- Truma ultra-heat water heater (495SL and 525SL only)
- Thetford domestic style swivel electric flush cassette toilet with header tank
- Restyled washroom layout



- Key-fob operated entry light & 12v isolation
- Electrical control panel over exterior door featuring 12v isolation, interior entry switch, alarm, battery and water level indicators
- Halogen down lighting in rear washroom





- 'Primus' wet central heating systems (535SL, 550GL and 625GL only)
- Internal fresh water tank with inspection hatch and internal drain release (8 gallon usable capacity)
- Water system with internal shurflo pump system can draw from either an aquaroll or mains water for summer use, or the internal water tank for winter use

- Aqua source mains water connection facility
- Micro switched semi-rigid piped water system
- Rigid waste hose water system

- Full inboard plumbing
- Fully sealed shower cubicle with uniquely styled bronze tinted revolving door (except 535SL)
- Shower set with on/off control

#### KITCHEN

New for 2001

- Electrolux 86 litre electronic power fridge (495SL, 535SL, 550GL and 625GL)
- Electrolux 135 litre power fridge/freezer (525SL only)
- Waste bin concealed in sink unit (model specific)
- Uremil rack in sink unit area (model specific)
- Stainless steel oven, hob and sink
- Colour co-ordinated microwave oven
- (495SL and 550GL only)
- Stoves oven and hob, recessed into kitchen unit
- Sink and drainer, recessed into kitchen unit
- Laminate to kitchen tops



#### LOUNGE & DINING AREA

New for 2000

- Choice of two luxurious fabrics
- Sprung upholstery to seats and backrests
- Luxury wall to wall fitted carpet
- Restyled ash framed rebated doors

- Ash framed lower doors (where applicable)
- Improved bed construction
- Fuller depth wrap round seating
- Satin steel door handles
- Corner display units to front seating area (model specific)
- Heki roof window with flyscreen and night blind
- Ash framed furniture doors with inlaid golden cherry panels
- Golden cherry furniture board
- Stylish rolled edged ash moulding to worktops and tables
- Full width front overhead lockers
- Beech sprung slats to all seats for improved comfort and cushion support
- Ergonomically adjusted backrests to front beds
- Four stylish scatter cushions
- Wrap round seating with occasional coffee table or optional chest of drawers with pull-out occasional table
- Roller steel runners to all drawers
- Large free standing table with designated storage locker
- Fitted quartz clock and barometer
- Concealed radio/CD player with speakers and CD storage facility



#### FITTINGS & EQUIPMENT

- Cameo embroidered entrance mat with fitted tray for brush out facility
- Caravan entrance step
- Ladder for upper bunk where fitted
- Wheeled waste water tank
- Isolation taps to all gas appliances

- Secure furniture fixings with bonded wall plates
- Seltz flyscreen and blinds to all windows
- Full exterior door flyscreen with floor protection plate

- Omnivent 3 speed 12v fan and skylight
- Smoke alarm

#### SECURITY

- High security key lock to exterior doors, battery compartment and cassette toilet door
- Concealed security data chip within caravan construction

- Identity number etched to windows and stamped on chassis member

- Rear lockable corner steadies (not including locks)
- IDM 2000 alarm system with passive infra red tilt sensor and car to caravan detection



- 1 New offside awning light
- 2 New Corner steady
- 3 New alloy wheels
- 4 Gas compartment
- 5 Electric
- 6 New kitchen waste bin<sup>8</sup>
- 7 New pull-out bed
- 8 New Truma heater
- 9 Front chest (option)
- 10 Reclining front seat
- 11 Stereo CD with storage
- 12 Cocktail cabinet
- 13 Heki roof window
- 14 Uremil rack
- 15 New AK52700 stabiliser
- 16 Electrolux 86 litre fridge
- 17 Optional Burgandy oven
- 18 Primus central heating boiler<sup>9</sup>
- 19 New Seitz 54 framed window
- 20 New exterior sealed wet locker

† In some models

# technical Specification

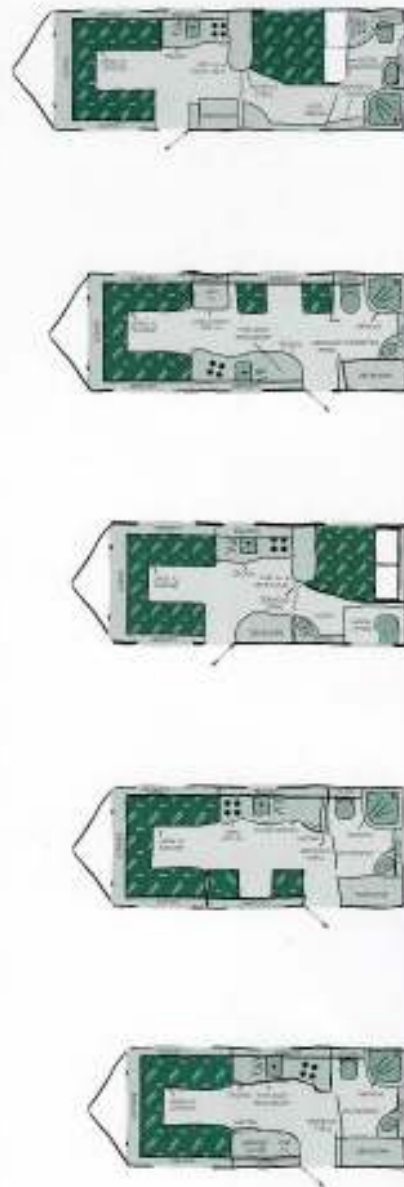

Model	49SSL	52SSL	53SSL	550GL	625GL
Berths	2	3 opt 4	4	3 opt 4	4
Axles	1	1	1	2	2
Internal Length (at bed box height)	5,09m/16'8"	5,36m/17'7"	5,36m/17'7"	5,85m/19'2"	6,35m/20'10"
Overall Width	2,23m/7'4"	2,23m/7'4"	2,23m/7'4"	2,23m/7'4"	2,23m/7'4"
Overall Height (inc. TV aerial)	2,80m/9'2"	2,80m/9'2"	2,89m/9'2"	2,71m/8'11"	2,71m/8'11"
Overall Length	6,68m/21'11"	6,96m/22'10"	6,96m/22'10"	7,45m/24'5"	7,95m/26'1"
Mass in Running Order (inc. 3% tolerance)	1328kg/26,1cwt	1380kg/27,2cwt	1404kg/27,6cwt*	1489kg/29,3cwt	1563kg/30,8cwt
Essential Habitation Equipment Payload	115kg/2,3cwt	115kg/2,3cwt	113kg/2,2cwt	113kg/2,2cwt	113kg/2,2cwt
Personal Effects Payload	108kg/2,1cwt	130kg/2,6cwt	130kg/2,6cwt	135kg/2,7cwt	140kg/2,8cwt
Optional Equipment Payload	49kg/1,0cwt	75kg/1,5cwt	53kg/1,0cwt	62kg/1,2cwt	34kg/0,7cwt
Maximum Technical Permissible Laden Mass	1600kg/31,5cwt	1700kg/33,5cwt	1700kg/33,5cwt	1800kg/35,4cwt	1850kg/36,4cwt
Axleing A/A Dimension	9,42m/30'11"	9,69m/31'9"	9,69m/31'9"	10,18m/33'5"	10,68m/35'0"
Tyre Size	195/70 R15 102	195/70 R15 102	195/70 R15 102	165R13 83T	165R13 83T

Bed Sizes	Front double		or one Single		and one single		Rear double		Side single		Side bunk	
Front double	205cm x 188cm/ 6'9" x 6'2"	205cm x 177cm/ 6'9" x 5'10"	205cm x 165cm/ 6'9" x 5'5"	188cm x 71cm/ 6'2" x 2'4"	188cm x 71cm/ 6'2" x 2'4"	188cm x 71cm/ 6'2" x 2'4"	188cm x 71cm/ 6'2" x 2'4"	189cm x 135cm 6'2" x 4'5"	180cm x 67cm/ 5'11" x 2'2"	180cm x 67cm/ 5'11" x 2'2"	172cm x 58cm/ 5'8" x 1'11"	172cm x 58cm/ 5'8" x 1'11"
or one Single	188cm x 71cm/ 6'2" x 2'4"	177cm x 71cm/ 5'10" x 2'4"	165cm x 71cm/ 5'5" x 2'4"	188cm x 71cm/ 6'2" x 2'4"	188cm x 71cm/ 6'2" x 2'4"	188cm x 71cm/ 6'2" x 2'4"	188cm x 71cm/ 6'2" x 2'4"	190cm x 137cm/ 6'3" x 4'6"	188cm x 71cm/ 6'2" x 2'4"	188cm x 71cm/ 6'2" x 2'4"	172cm x 58cm/ 5'8" x 1'11"	172cm x 58cm/ 5'8" x 1'11"
and one single	188cm x 71cm/ 6'2" x 2'4"	188cm x 71cm/ 6'2" x 2'4"	188cm x 71cm/ 6'2" x 2'4"	188cm x 71cm/ 6'2" x 2'4"	188cm x 71cm/ 6'2" x 2'4"	188cm x 71cm/ 6'2" x 2'4"	188cm x 71cm/ 6'2" x 2'4"	188cm x 71cm/ 6'2" x 2'4"	188cm x 71cm/ 6'2" x 2'4"	188cm x 71cm/ 6'2" x 2'4"	172cm x 58cm/ 5'8" x 1'11"	172cm x 58cm/ 5'8" x 1'11"
Rear double	188cm x 71cm/ 6'2" x 2'4"	188cm x 71cm/ 6'2" x 2'4"	188cm x 71cm/ 6'2" x 2'4"	188cm x 71cm/ 6'2" x 2'4"	188cm x 71cm/ 6'2" x 2'4"	188cm x 71cm/ 6'2" x 2'4"	188cm x 71cm/ 6'2" x 2'4"	188cm x 71cm/ 6'2" x 2'4"	188cm x 71cm/ 6'2" x 2'4"	188cm x 71cm/ 6'2" x 2'4"	172cm x 58cm/ 5'8" x 1'11"	172cm x 58cm/ 5'8" x 1'11"
Side single	188cm x 71cm/ 6'2" x 2'4"	188cm x 71cm/ 6'2" x 2'4"	188cm x 71cm/ 6'2" x 2'4"	188cm x 71cm/ 6'2" x 2'4"	188cm x 71cm/ 6'2" x 2'4"	188cm x 71cm/ 6'2" x 2'4"	188cm x 71cm/ 6'2" x 2'4"	188cm x 71cm/ 6'2" x 2'4"	188cm x 71cm/ 6'2" x 2'4"	188cm x 71cm/ 6'2" x 2'4"	172cm x 58cm/ 5'8" x 1'11"	172cm x 58cm/ 5'8" x 1'11"
Side bunk	188cm x 71cm/ 6'2" x 2'4"	188cm x 71cm/ 6'2" x 2'4"	188cm x 71cm/ 6'2" x 2'4"	188cm x 71cm/ 6'2" x 2'4"	188cm x 71cm/ 6'2" x 2'4"	188cm x 71cm/ 6'2" x 2'4"	188cm x 71cm/ 6'2" x 2'4"	188cm x 71cm/ 6'2" x 2'4"	188cm x 71cm/ 6'2" x 2'4"	188cm x 71cm/ 6'2" x 2'4"	172cm x 58cm/ 5'8" x 1'11"	172cm x 58cm/ 5'8" x 1'11"





INVESTOR IN PEOPLE



Bessacarr Caravans, Dunswell Road, Cottingham, East Yorkshire HU16 4JX. Tel: 01482 847332 Fax: 01482 841042  
e-mail: enquiry@swift leisure.co.uk website: www.bessacarrcaravans.co.uk

A MEMBER OF THE SWIFT GROUP

This brochure does not constitute an offer by Swift Group Limited (Swift). Swift reserves the right to alter specifications and prices at any time as materials and conditions demand. Distributors and dealers sell Bessacarr products on their own account and not as agents of Swift. Accordingly, they have no authority to bind Swift or to make any representation or undertaking whatsoever on behalf of Swift.

The touring caravans described in this brochure are designated by their model year. The model year runs from 1 September to 31 August and the despatch of 2001 models will have commenced on or after 1 September 2000.

Printed September 2000

Model cars courtesy of Volvo Cars UK Limited

To reserve your place on a luxury tour or see Bessacarr products being produced in one of Europe's most sophisticated factories, simply call the number above and ask for 'holiday home'.