



TECHNICAL BULLETIN

No: LA-310-001
Issue: 1
Date: 10 Nov 2005

CIRCULATE: TO	Service Mgr	Warranty	Workshop	Body Shop	Parts
	X	X	X	X	X

SECTION: 310-00

Fuel Filler Flap Latch Repair

AFFECTED VEHICLE RANGE:

LR3 (LA) ALL

CONDITION SUMMARY:

DIFFICULTY OPENING OR CLOSING THE FUEL FILLER FLAP

A customer may report a concern of difficulty in opening or closing the fuel filler flap.

Cause: Fuel filler flap release catch parts can break during use which may result in difficulty in the opening or closing of the flap.

Action: Component parts of the fuel filler flap release catch are now available as individual spare parts. Previously the entire fuel filler flap assembly had to be replaced to affect a latch repair. This Technical Bulletin announces availability of the release catch parts for repairs. Should a customer express concern regarding the above, only the appropriate part(s) should be used to repair the vehicle.

PARTS:

- | | | | |
|---|-----------------|-------------------------------------|-------|
| 1 | BPA780120 | Fuel filler flap spring | Qty 1 |
| 2 | BPA780110 | Fuel filler flap ejector (retainer) | Qty 1 |
| 3 | BPA780100 | Fuel filler flap actuator | Qty 1 |
| 4 | ARV780010 | Fuel filler flap catch box | Qty 1 |
| 5 | CAL500070 | Fuel filler flap catch seal | Qty 1 |

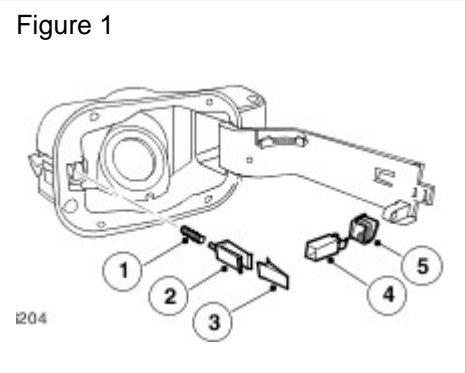

WARRANTY:



NOTE: Repair procedures are under constant review, and therefore times are subject to change; those quoted here must be taken as guidance only. Always refer to DDW to obtain the latest repair time.

DDW requires the use of causal part numbers. Labor only claims must show the causal part number with a quantity of zero.

Description	SRO	Time (Hours)	Condition Code	Causal Part
Replace fuel filler flap release mechanism (illustration items 1,2,3)	19 55 16	0.10	01	Use part replaced from listing above
Replace fuel filler flap catch/seal (illustration items 4,5)	19 55 15	0.10		

Normal warranty policy and procedures apply.

NOTE: The information in Technical Information bulletins is intended for use by trained, professional technicians with the knowledge, tools, and equipment required to do the job properly and safely. It informs these technicians of conditions that may occur on some vehicles, or provides information that could assist in proper vehicle service. The procedures should not be performed by "do-it-yourselfers."

If you are not a Retailer, do not assume that a condition described affects your vehicle. Contact an authorized Land Rover service facility to determine whether the bulletin applies to a specific vehicle.



REPAIR PROCEDURE

REPLACE PARTS AS REQUIRED TO REPAIR LATCH

1. Open the fuel filler flap.
2. Renew the catch mechanism parts as necessary.