



## Rear Door Latch (76.37.13)

### Removal

1. Remove the rear door window motor and regulator assembly. For additional information, refer to [Rear Door Window Regulator and Motor \(86.25.05\)](#) (Section 501-11)

2.  **CAUTION: Release the exterior door handle and screw cover clips from inside the door.**

Remove the rear door exterior handle. For additional information, refer to [Exterior Rear Door Handle \(76.58.02\)](#) (Section 501-14)

3. Release the remote control cable.
  - ▶ Release the grommet.
4. Release the door exterior handle mechanism.
  - ▶ Remove the 2 Torx screws.
  - ▶ Remove the locking pin.
5. Remove the rear door latch assembly.
  - ▶ Disconnect the electrical connector.
  - ▶ Remove the 3 Torx screws.

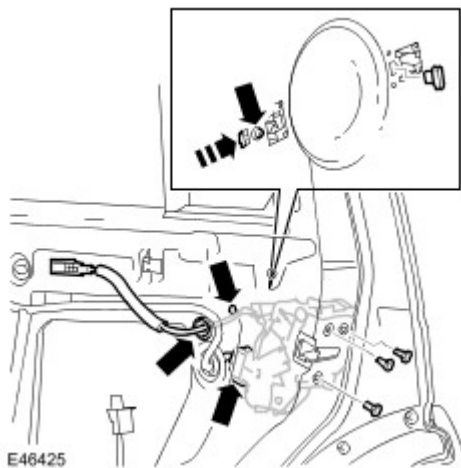

6. **NOTE :**
  - Do not disassemble further if the component is removed for access only.
  - Remove the door latch remote control cable.
    - ▶ Release the cable from the abutment bracket.
    - ▶ Remove the cable from the lever.

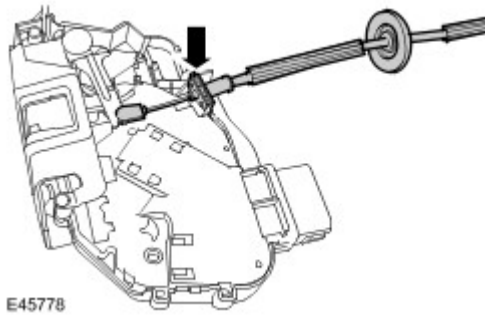

7. Release the exterior door handle mechanism cable from the door latch.
  - ▶ Release the cable from the abutment bracket.
  - ▶ Remove the cable from the lever.

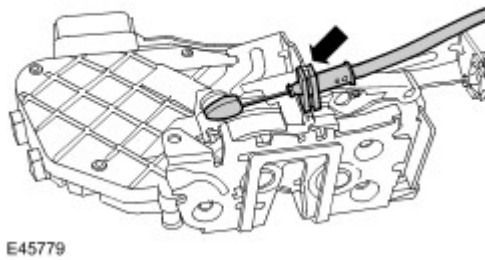

## Installation

1. Connect the door exterior handle mechanism cable to the door latch.
  - ▶ Connect the cable to the lever.
  - ▶ Secure the cable to the abutment bracket.
2. Install the remote control cable to the door latch.
  - ▶ Connect the cable to the lever.
  - ▶ Secure the cable to the abutment bracket.
3. Set the exterior handle mechanism.
  - ▶ Rotate the lever.
  - ▶ Engage the retaining tang.

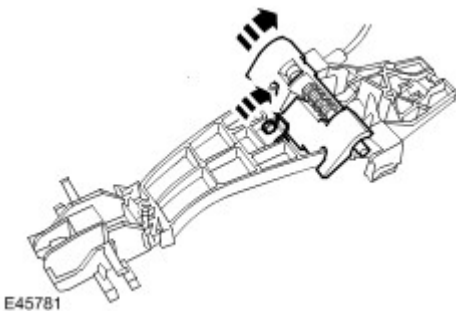

- 4 . Install the rear door latch assembly.
  - ▶ Tighten the Torx screws to 10 Nm (7 lb.ft).
  - ▶ Connect the electrical connector.
- 5 . Install the door exterior handle mechanism.
  - ▶ Position the mechanism to the door.
  - ▶ Fit the locking pin.
  - ▶ Install and tighten the Torx screws.
- 6 . Position the remote control cable to the door.
  - ▶ Install the grommet.
- 7 . Install the rear door exterior handle. For additional information, refer to [Exterior Rear Door Handle \(76.58.02\)](#) (Section 501-14)
- 8 . Install the rear door window motor and regulator assembly. For additional information, refer to [Rear Door Window Regulator and Motor \(86.25.05\)](#) (Section 501-11)