

Towing

Removing the tow bar

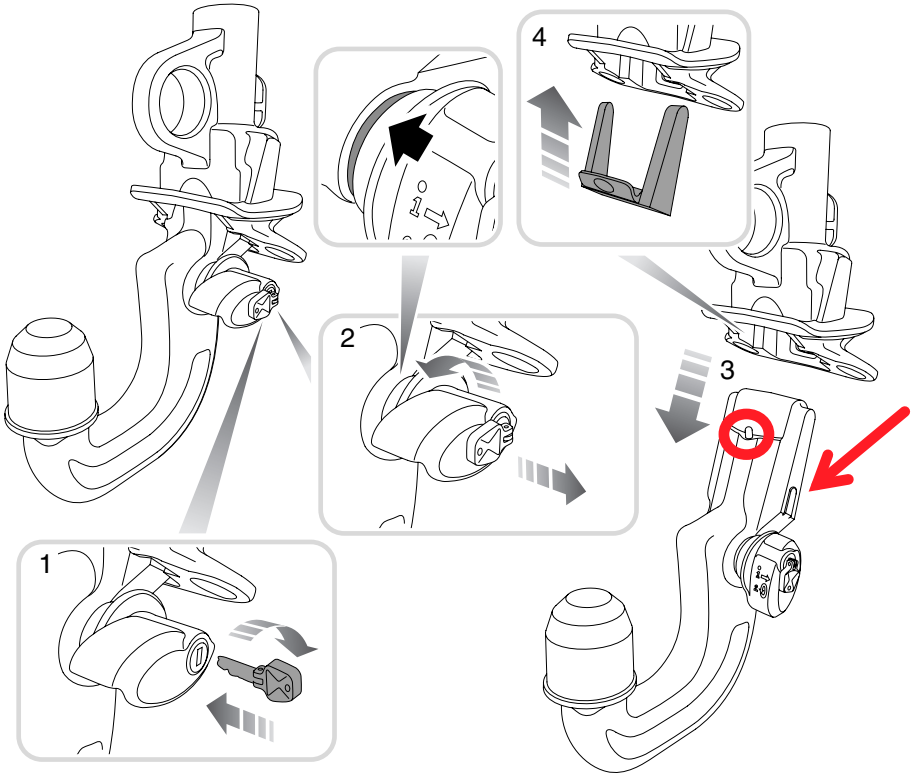

H5630G

1. Insert the key and turn it clockwise to unlock the tow bar.
2. To remove the tow bar, pull the handle outwards and rotate the handle anticlockwise until a click is heard. The marker on the handle should show red.
3. Carefully lower the tow bar and place it in its stowage area and fully secure it.
4. Replace the protective towing cover in the tow bar mounting. Press the bottom of the cover to fix it in position.